

DOUGLAS 05

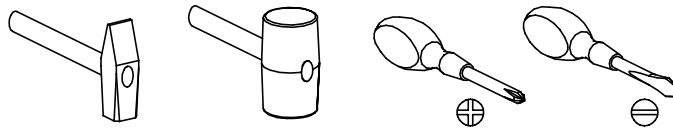

Narzędzia potrzebne do montażu



UWAGA !!!

MONTOWANIE USZKODZONYCH
ELEMENTÓW POWODUJE UTRATĘ
GWARANCJI

| Nr | D[mm] | S[mm] | G[mm] | Ilość |
|----|-------|-------|-------|-------|
| 1 | 1370 | 450 | 48 | 1 |
| 2 | 1370 | 450 | 48 | 1 |
| 3 | 1330 | 25 | 16 | 2 |
| 4 | 800 | 422 | 16 | 1 |
| 5 | 800 | 422 | 16 | 1 |
| 6 | 800 | 100 | 32 | 1 |
| 7 | 800 | 100 | 32 | 1 |
| 8 | 833 | 405 | 16 | 1 |
| 9 | 833 | 405 | 16 | 1 |
| 10 | 440 | 380 | 16 | 2 |
| 11 | 1360 | 856 | 2,5 | 1 |
| 12 | 435 | 190 | 16 | 4 |
| 13 | 400 | 150 | 16 | 4 |
| 14 | 400 | 150 | 16 | 4 |
| 15 | 360 | 150 | 16 | 4 |
| 16 | 390 | 405 | 2,5 | 4 |
| 17 | 772 | 365 | 16 | 1 |
| 18 | 772 | 365 | 16 | 1 |

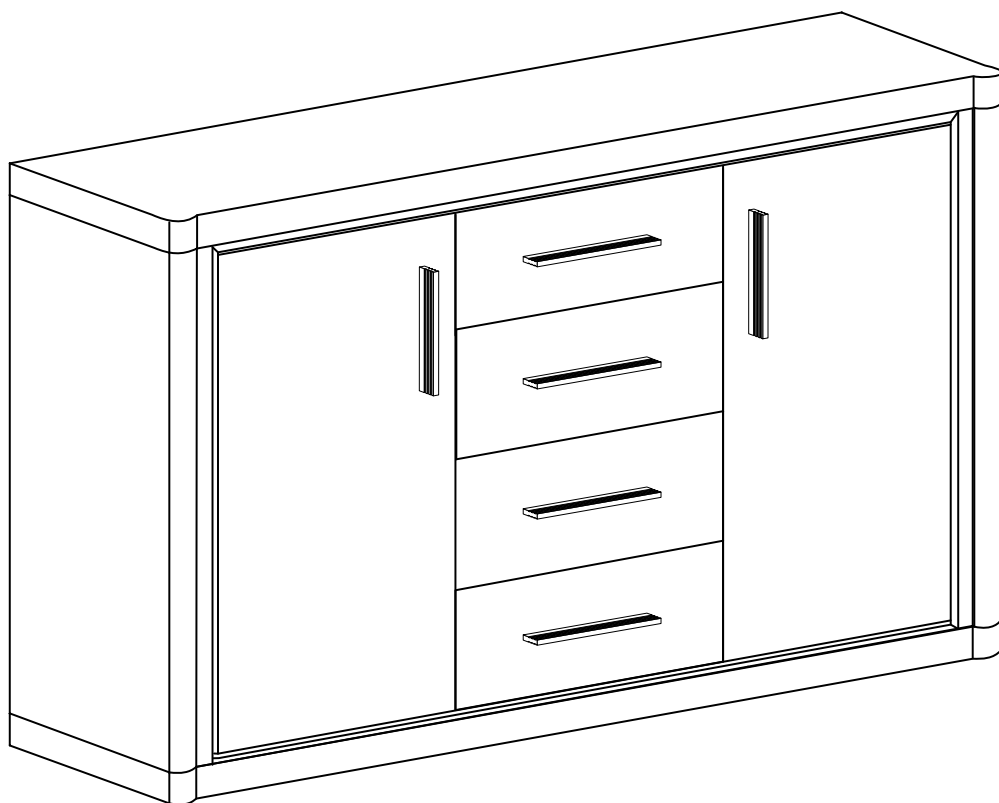

W przypadku reklamacji proszę podać numer pakowacza znajdujący się na kartonie.

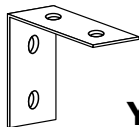

Y - 1 St.

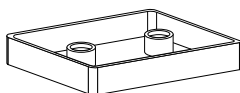

A - 6 St.

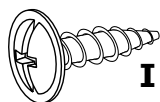

I - 2 St.
3,5x16 mm

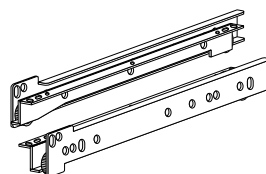

T - 4 Kpl.



X1 - 30 St.

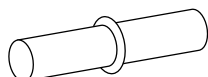

P - 8 St.

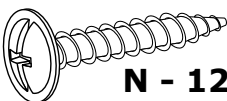

N - 12 St.
4x27 mm

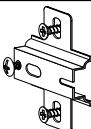

C - 4 St.

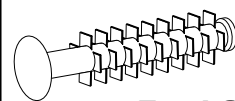

F - 16 St.

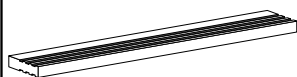

U - 6 St.

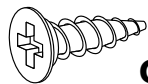

G - 8 St.
3,5x16 mm

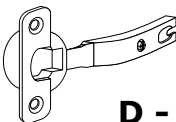

D - 4 St.

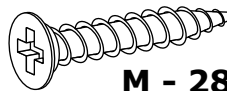

M - 28 St.
3,9x25 mm



L - 30 St.

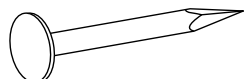

E - 90 St.

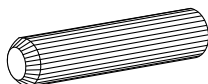

B - 32 St.

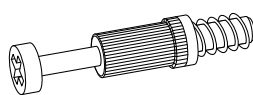

K - 30 St.

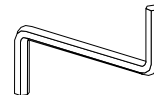

Z - 1 St.

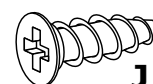

J - 16 St.
5x13 mm

I

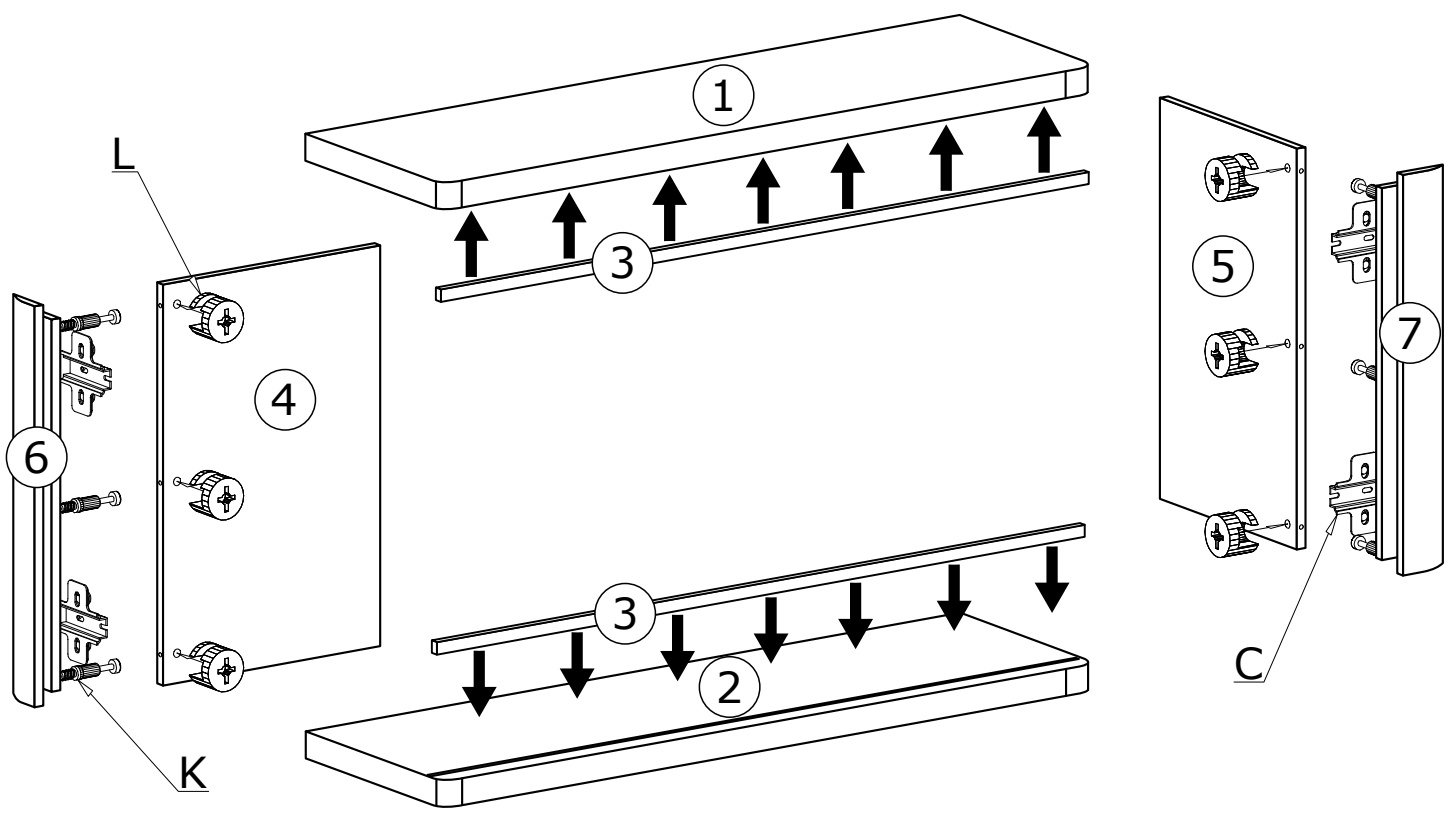

II

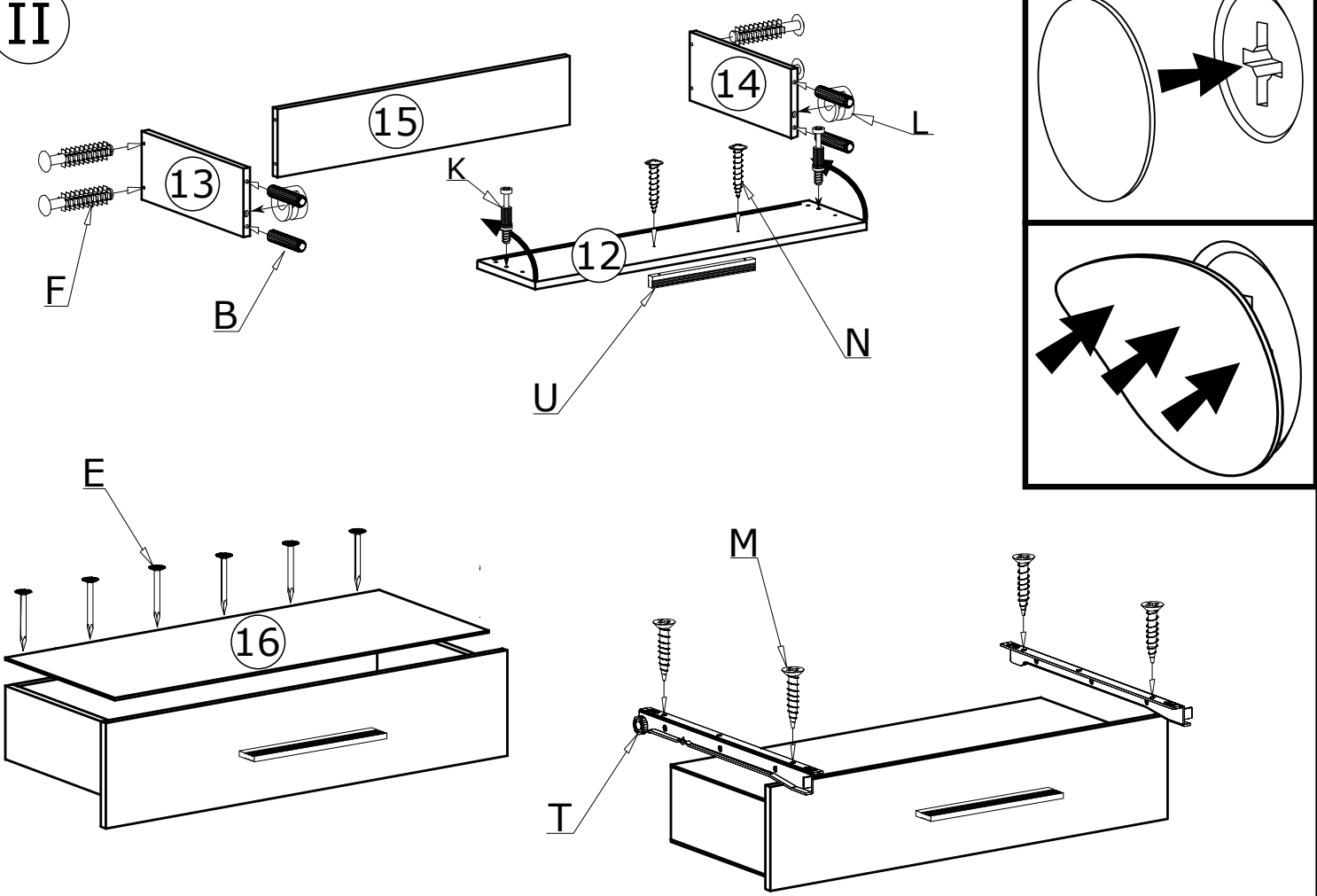

III

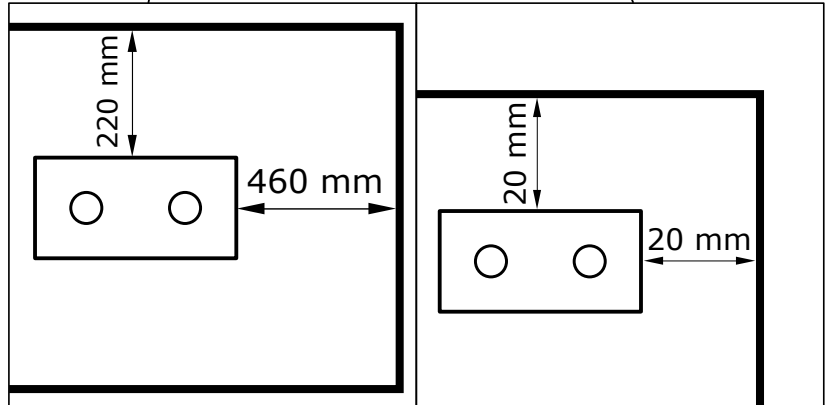
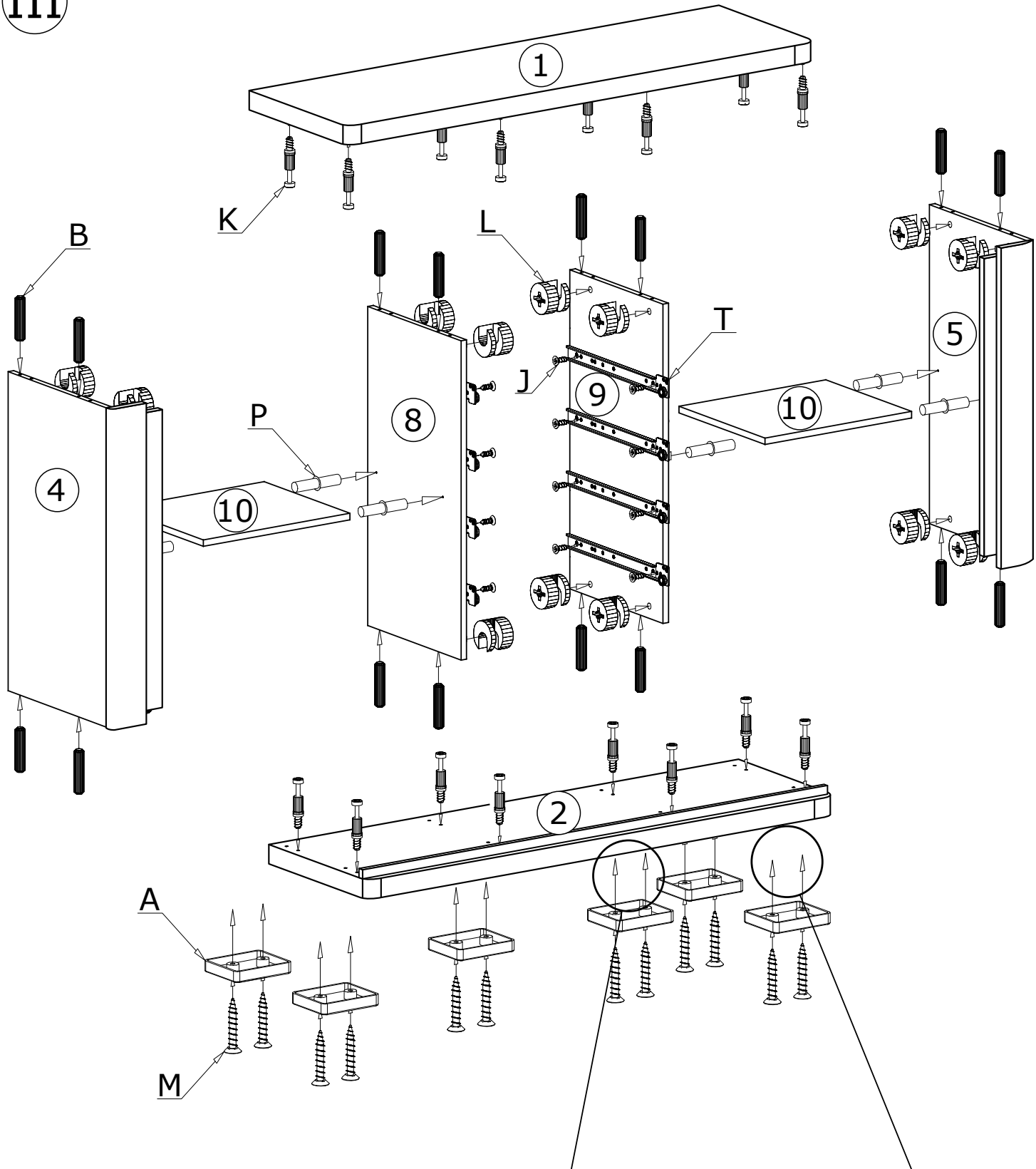

IV

90X 

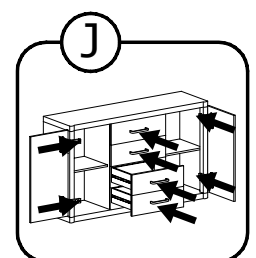
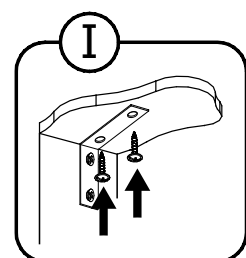
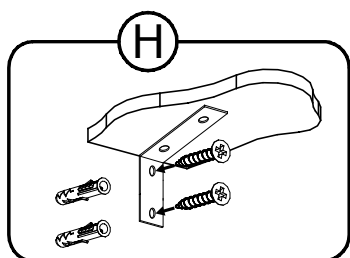
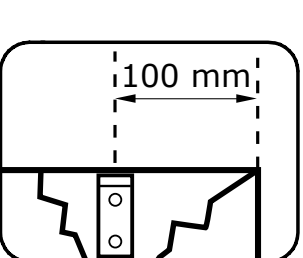
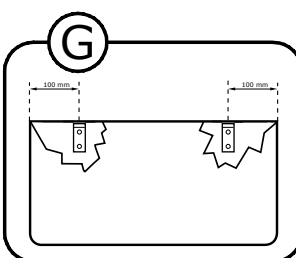
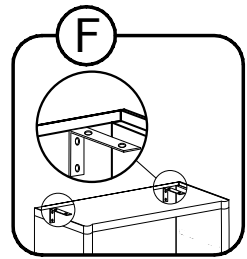
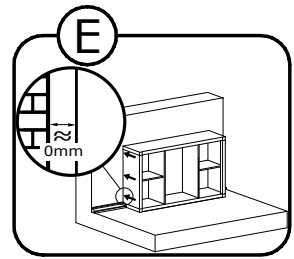
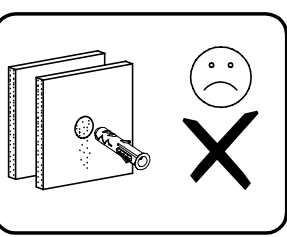
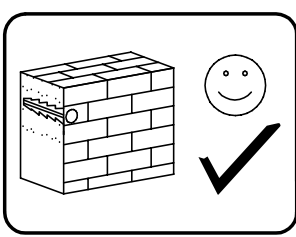
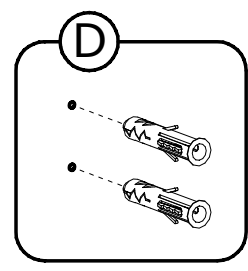
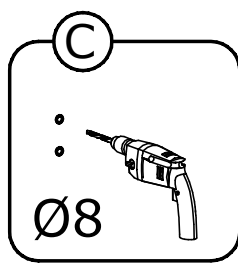
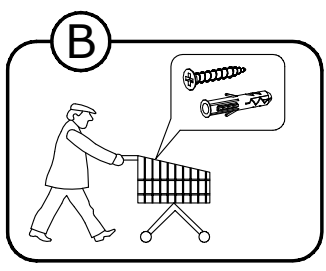
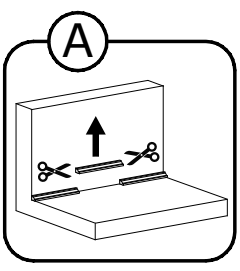
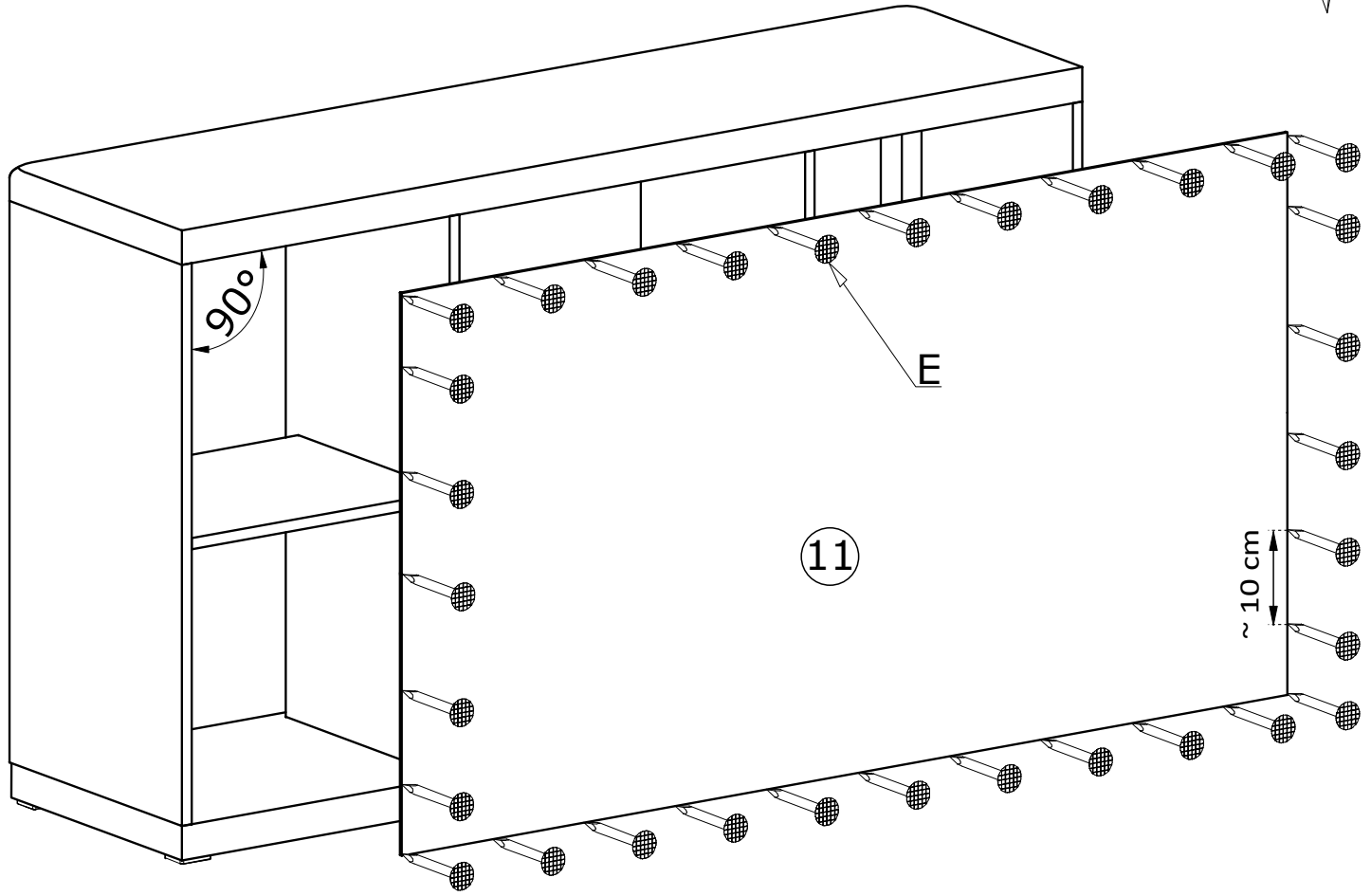

V

